

HBG2 DOME

UFC High Bay Light

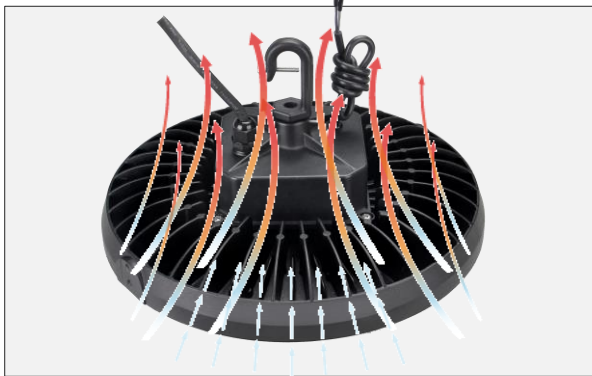

- DLC5.1 Premium Listed
- ETL, cETL, CB, CE, TUV, SAA Listed
- High Lumens 150lm/w
- IP65 Wet Location
- 1-10V dimming in standard
- 5 Years warranty



Good Heat Dissipation

Die-Casting Aluminum body, Efficient heat dissipation, directing heat up and out. makes little lumens depreciation.

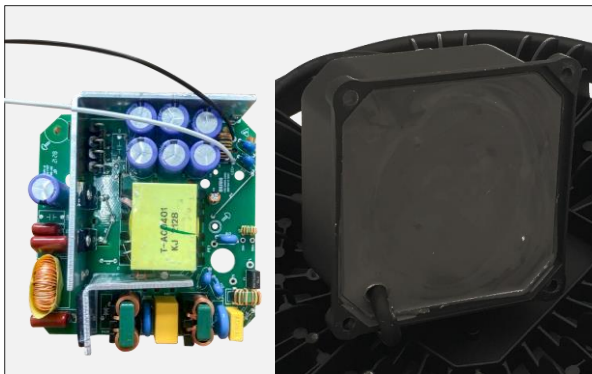

High Quality Driver

Constant Current High quality driver with silica gel.
Multi-Voltage: 100-277/347Vac
1-10V dimming in standard.



DOME Cover Design

Anti-Glare
Up to 150lm/w optional
beam angle : 120°



Saving Shipping cost Packing Design

Extremely compact and safety package design,
40HQ Container can load around:
4200pcs 100W/150W
4000pcs 200W/240W

Parameter

Model No.	HB-100G-xxK-x	HB-150G-xxK-x	HB-200G-xxK-x	HB-240G-xxK-x
Wattage	100W	150W	200W	240W
Luminous Efficacy	150lm/w	150lm/w	150lm/w	150lm/w
Lumens output	15000lm	22500lm	30000lm	36000lm
HID/MF Equivalent	250-400W	400-600W	700-1000W	800-1200W
Fixture Weight	2.1Kg(4.6lb)	2.5Kg(5.5lb)	3.5Kg(7.7lb)	3.5Kg(7.7lb)
LEDs Brand	Lumileds SMD2835/3030			
CCT	3000K, 4000K, 5000K,5700K			
CRI	70+ or 80+			
Beam Angle	120°			
Input Voltage	100-277/100-347Vac 50-60Hz			
Dimming	1-10V dim in standard			
Power Factor	>0.95			
IP Rating	IP65 /Wet Location			
Working Temp.	-40° C ~ 50° C (-40° F~122° F)			
Storage Temp.	-40° C ~ 70° C (-40° F~158° F)			
Finish	Black (White, Gary customized)			
Housing	Die-casting Aluminum			
Diffuser	PC Lens			
Installation	Hanging, Mounting			
Lifespan(>70)	>100,000 Hours			
Certification	ETL, cETL, DLC, CE, RoHs, CB, TUV-Mark, SAA			

Dimension

Unit: mm(inch)

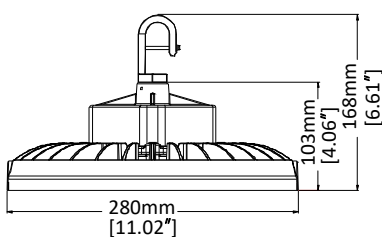

100W/150W

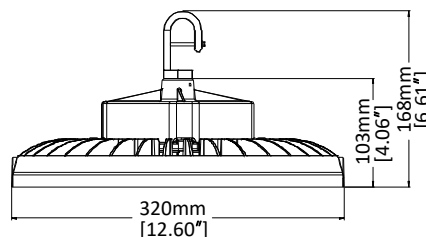

200W/240W

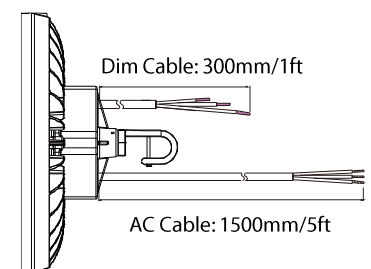

Cable Length

Photometric

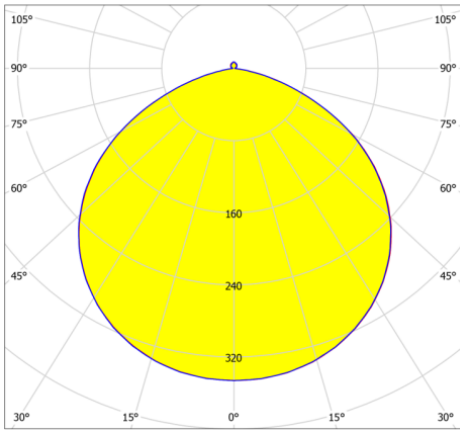

Order Information

Sample: HB-150G-50K-D

Product Family	CCT	Function
HB-100G = 100W	30K = 3000K	Blank = No Dim
HB-150G = 150W	40K = 5000K	D = 1-10V Dimming
HB-200G = 200W	50K = 5000K	S = Sensor
HB-240G = 240W	57K = 5700K	
	65K = 6500K	
In Standard	Options (add as Suffix)	Accessories (order Separately)
Black Finish 1.5m/5ft AC Cable 150lm/w CRI>70 Input Voltage: 100-277Vac 50/60Hz	MK = Mounting Bracket Kits WH = White Finish (MOQ>1000pcs) Other customized	MK = Mounting Bracket SK = Handing Chain 1m HB-G-90PCR = 90 PC Reflector

Package Information

ITEM	QTY/CTN	G. W.	CTN SIZE
HB-100G	4pcs	10kg(22lbs)	63x32.5x31cm (24.8"x12.8"x12.2") (0.064cbm)
HB-150G	4pcs	10kg(22lbs)	63x32.5x31cm (24.8"x12.8"x12.2") (0.064cbm)
HB-200G	4pcs	12kg(27lbs)	57x34.5x34.5cm (22.4"x22.4"x13.6") (0.068cbm)
HB-240G	4pcs	12kg(27lbs)	57x34.5x34.5cm (22.4"x22.4"x13.6") (0.068cbm)

Container Loading QTY

ITEM	PCS/Pallet (1.2x1x2m)	20GP (With Pallet)	40HQ (With Pallet)	20GP (No Pallet)	40HQ (No Pallet)
HB-100G				1760pcs	4300pcs
HB-150G				1760pcs	4300pcs
HB-200G				1600pcs	4000pcs
HB-240G				1600pcs	4000pcs